

*Built to perfection
...to suit your Lifestyle*

FOR BOOKINGS CALL ☎ 99452 71353 | 81971 40844



Kirthi
CONSTRUCTION

3rd Floor, Maithri Complex, Udupi - 576101, Karnataka
Tele: +91 820 2530655 | Email: enquiry@kirthiconstruction.com

 kirthiconstruction.com

Follow us at  facebook.com/KirthiCons

____ Architect _____
Ace Technocrats Pvt. Ltd., Udupi

This brochure is purely conceptual and is not legal offering. The Promoters / Architects reserve the rights to add/delete/any details/specifications/elavation mentioned herein.



Kirthi
Palnville
...Luxury Apartments

Luxurious Homes

WITH MODERN AMENITIES

Kirthi Palmville... A commune of designer residential apartments, with truly a village ambience to complement the needs of the urban clients. Palmville will be a home away for the clients in the heart of Udupi. Carefully designed to create a pleasant and secure living environment, Palmville is a highly secured gated community.

Palmville offers tremendous visual variety, with aesthetically designed apartments. Residents can enjoy a finest living environment. The project includes a Mini Tree forest and a tree house, incorporating a state of the art Swimming pool, children's play area and Independent Club House with an Indoor Gymnasium. Palmville has 24 hours security service, a power backup generator and beautiful gardens. If you love nature, this is the place to revel in it.

Nestled amongst acres of greens, your home at Palmville will be surrounded by theme-based gardens, each with a unique character. Jogging trail, green lawns refresh your senses.

The outdoor games facilities challenge you for your physical fitness. The green lawns and sand pits give children all the space they need to make up their own games. The club house and the swimming pool recharge your spirits whenever you need.



2&3 BHK

...Spacious Luxury apartment
to suit your needs...



Block-B
15 Floors

Live in Exotic Style in your friendly neighborhood of UDUPI



Kirthi
Palmville

...Luxury Apartments

RERA NO: PRM/KA/RERA/1273/318/PR/210422/004842



Enjoy a finest living

MODERN AMENITIES

- Clubhouse
- Swimming Pool
- Indoor Gym
- 60% open space
- Total Water Recycle system by STP
- Landscape, big trees and garden
- CCTV and High Security Provisions
- Walking Track: Entire plot of 3.80 acres have walking Zone
- Kids Play zone: Dedicated Children's Play area as well as outdoor games area.



2&3 BHK

...Spacious Luxury apartment to suit your needs...

...Finest Luxury Apartments to suit your needs...



SPECIFICATION

- Flooring: 1m x 1m Vitrified in Hall
 - 800mm x 800mm Vitrified in Bedrooms
 - 1200mm x 600mm Kitchen
- Kitchen: Granite Platform
 - Nirali /Franke Sink
 - Tiles 2' feet above platform
- Bathroom: Tiles upto ceiling glass Cuticle for shower area in attached Bathrooms
- Sanitary Ware: Duravit/ Jaquar
- Taps: Jaquar or similar make
- Electrical: Panasonic or similar switches polycab or RR cables and wires
- Doors: Teakwood Main Doors (Melamine Polish) Flush door Veener with Melamine polish FRP Doors for Bathrooms. Godrej handles and fittings
- Window: Jindal Aluminium Anodized.
- Security: Video Door Phones/Panasonic or Legrand
- Intercom: For all flats



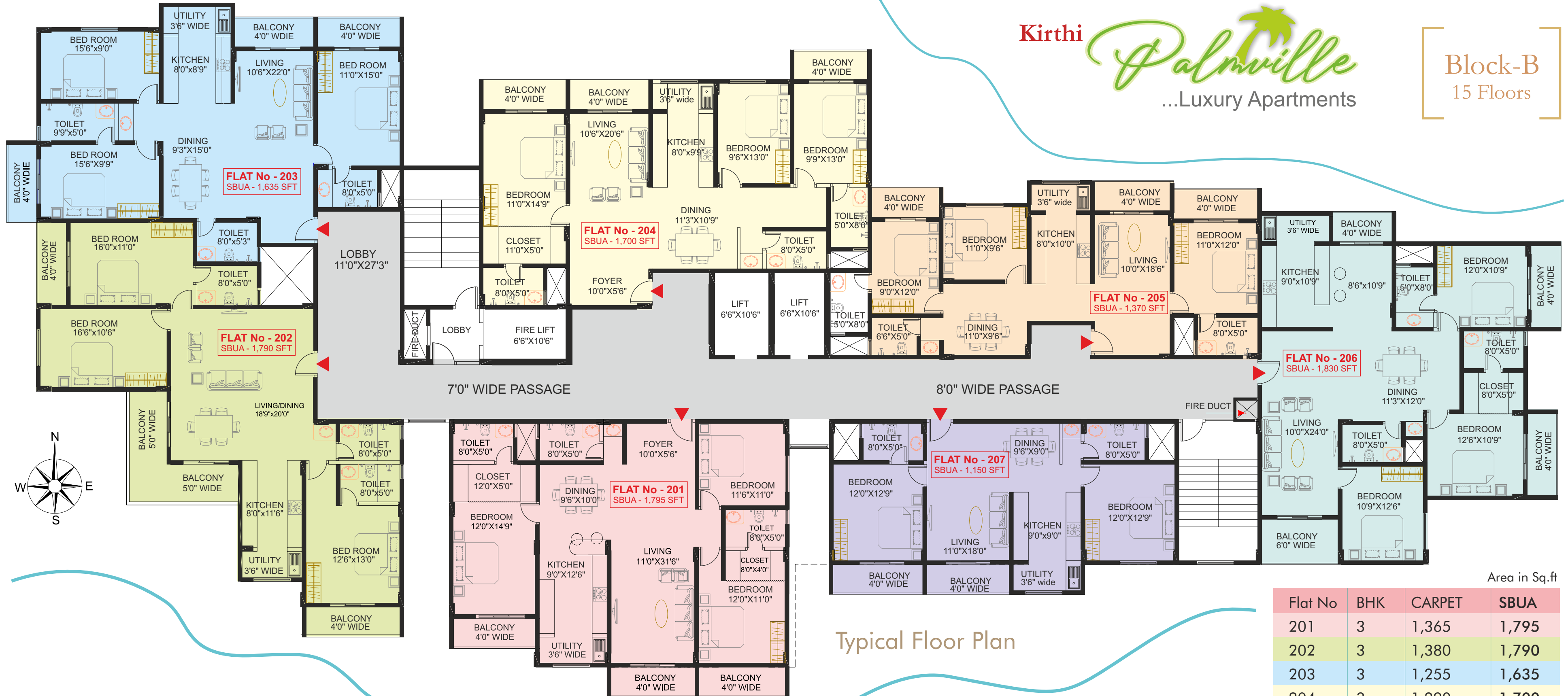

Area in Sq.ft

Flat No	BHK	CARPET	SBUA
201	3	1,365	1,795
202	3	1,380	1,790
203	3	1,255	1,635
204	3	1,290	1,700
205	3	1,030	1,370
206	3	1,395	1,830
207	2	870	1,150

Floor Plan

3 BHK Flat # 201



Super Built-up: 1,795 Sqft.

- Carpet Area: 1,365 Sqft.
- 3 Bedrooms
- Drawing Room
- Dining Room
- Kitchen with utility Area
- 3 Toilets
- 3 Balcony

Floor Plan

3 BHK Flat # 206



Super Built-up: 1,830 Sqft.

- Carpet Area: 1,395 Sqft.
- 3 Bedrooms
- Drawing Room
- Dining Room
- Kitchen with utility Area
- 3 Toilets
- 3 Balcony



Project Site Plan
- 3.80 acres

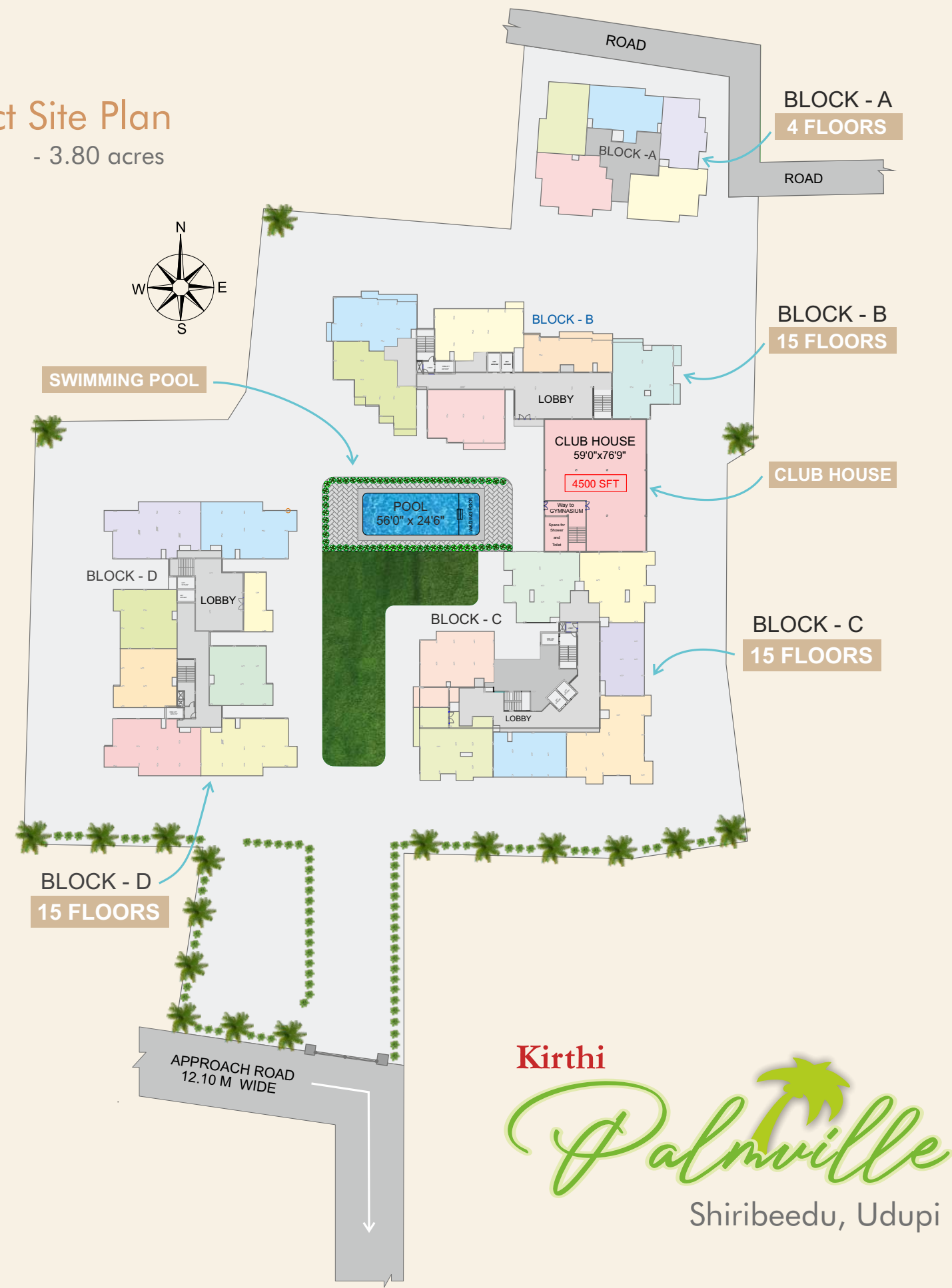

Kirthi Palmville
- A most convenient location in Udupi City

Kirthi Palmville... Located in Shiribeedu, heart of the Udupi City just few minutes' walk from the main & city bus stand of Udupi, Palmville is spread over a vast plot of 3.80 acres with 60% open space. Palmville is an aesthetically designed residential complex thoughtfully created giving a safe, friendly environment. Strong emphasis has been placed on avenue tree planting, hedging and gardens, creating a delightful landscaped setting and a walking Zone.

